





# Severn Vale School

Information Event



## 1. Three Storey Extension & Internal Reconfiguration

The new extension would provide two additional classrooms and a small cafe to help ease congestion in the dining hall. The extension would include a lift which - along with internal reconfiguration to create a new corridor - would greatly improve the circulation within the block for all students, including those with limited mobility.

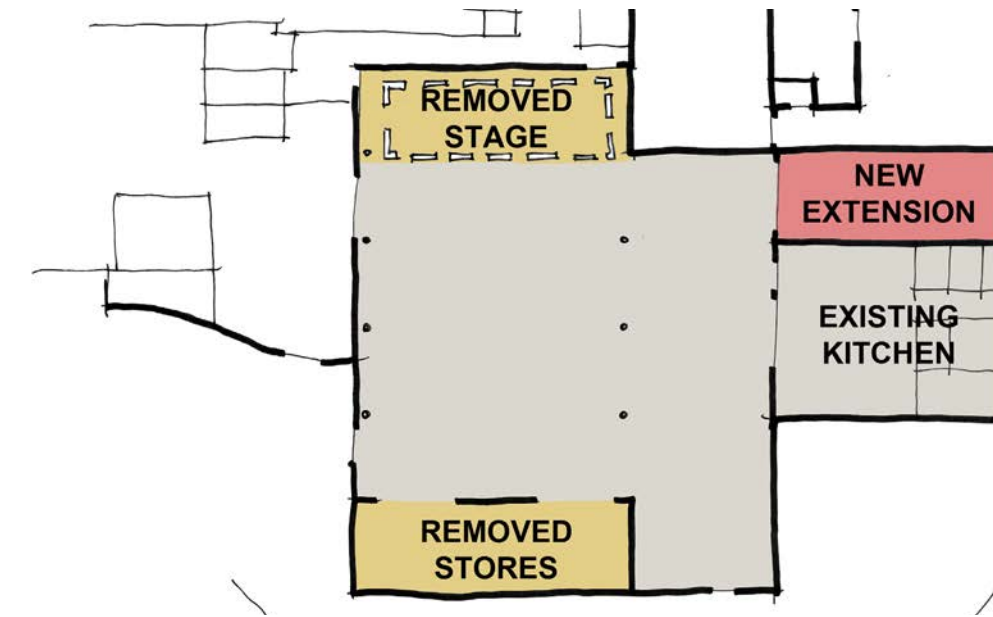

## 2. Single Storey Extension To Dining

This small extension would allow the school additional space to incorporate an additional servery. This would allow more children to be served meals at lunchtime. The hall stage and stores will be removed internally to increase seating space.

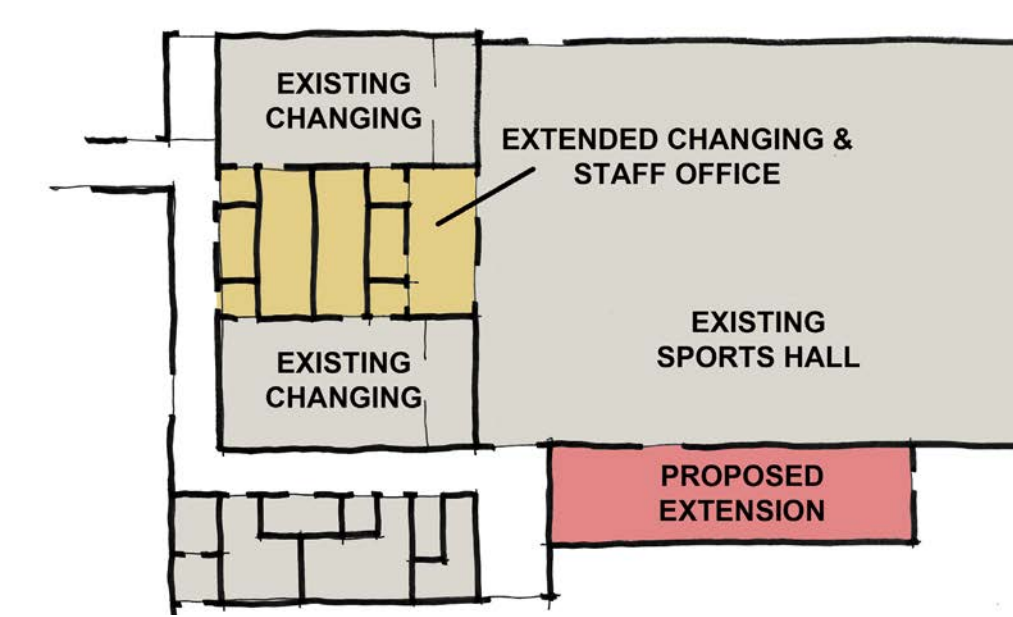

## 3. Extension to Sports Hall & Changing Room Improvements

With storage being lost from the main hall, and additional storage being reconfigured to improve the changing facilities, a new store is proposed on the external wall of the hall.

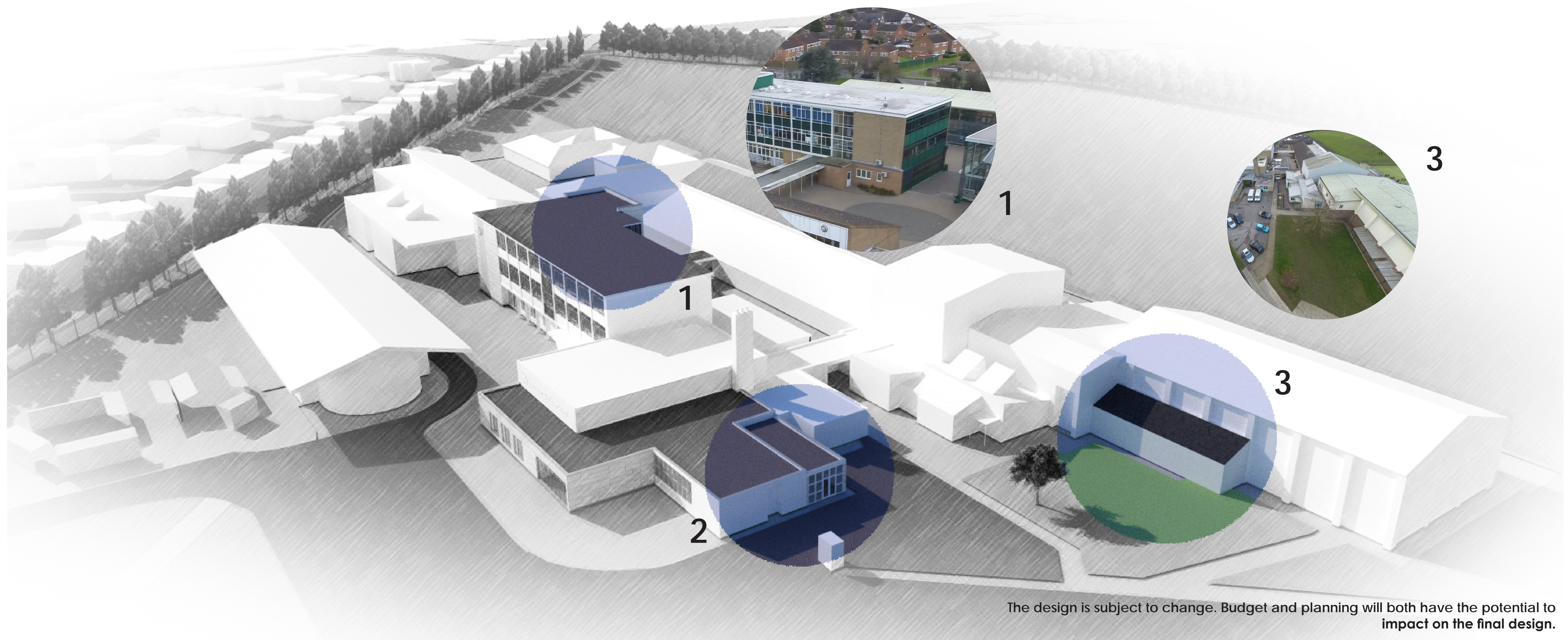

The design is subject to change. Budget and planning will both have the potential to impact on the final design.



# Severn Vale School

Information Event

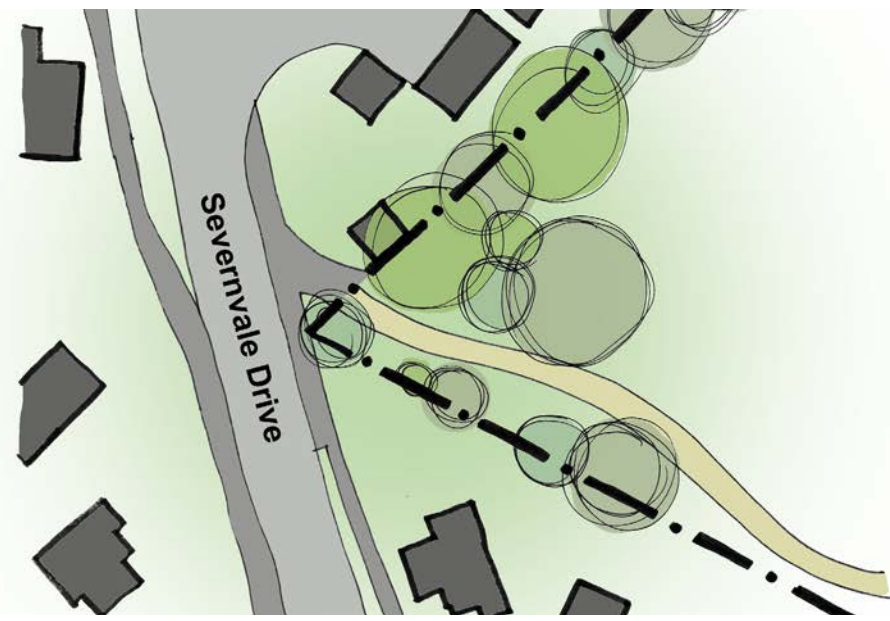

4. Secondary Access Point Onto Severn Vale Drive

A new pedestrian access point from the corner of the school field from Severn Vale Drive. This would be a secure gate, opened only at the start and end of each day to ease congestion on School Lane.



5. Overcladding Three Storey Block (Corner Element)

Overcladding the existing brick corner to tie the existing building to the new language that the extension is looking to achieve.

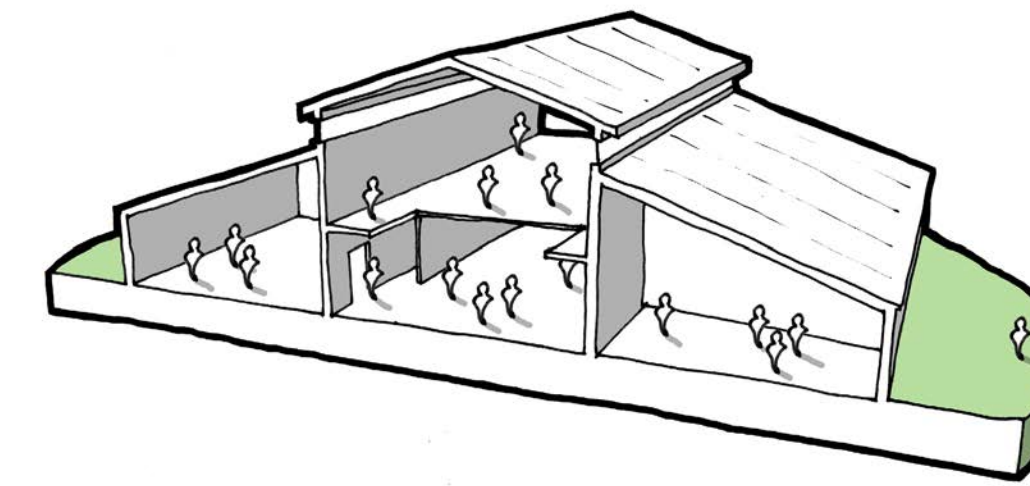

6. New Roof On Science Block & Internal Reconfiguration

A new pitched roof across the middle section of the science block, which is currently a flat roof and leaking. This could open up the possibility of introducing a new floor of accommodation at a later date.

Additionally, the existing science labs will be reconfigured to replace 9 labs with 11 teaching spaces to suit a more modern approach to science education.



7. Overcladding & New Windows To Main Entrance/Dining

To give the front of the school a new look and help establish a unified approach to the external appearance of the school, we are looking to overclad the dining hall and introduce some new windows, should budget allow.

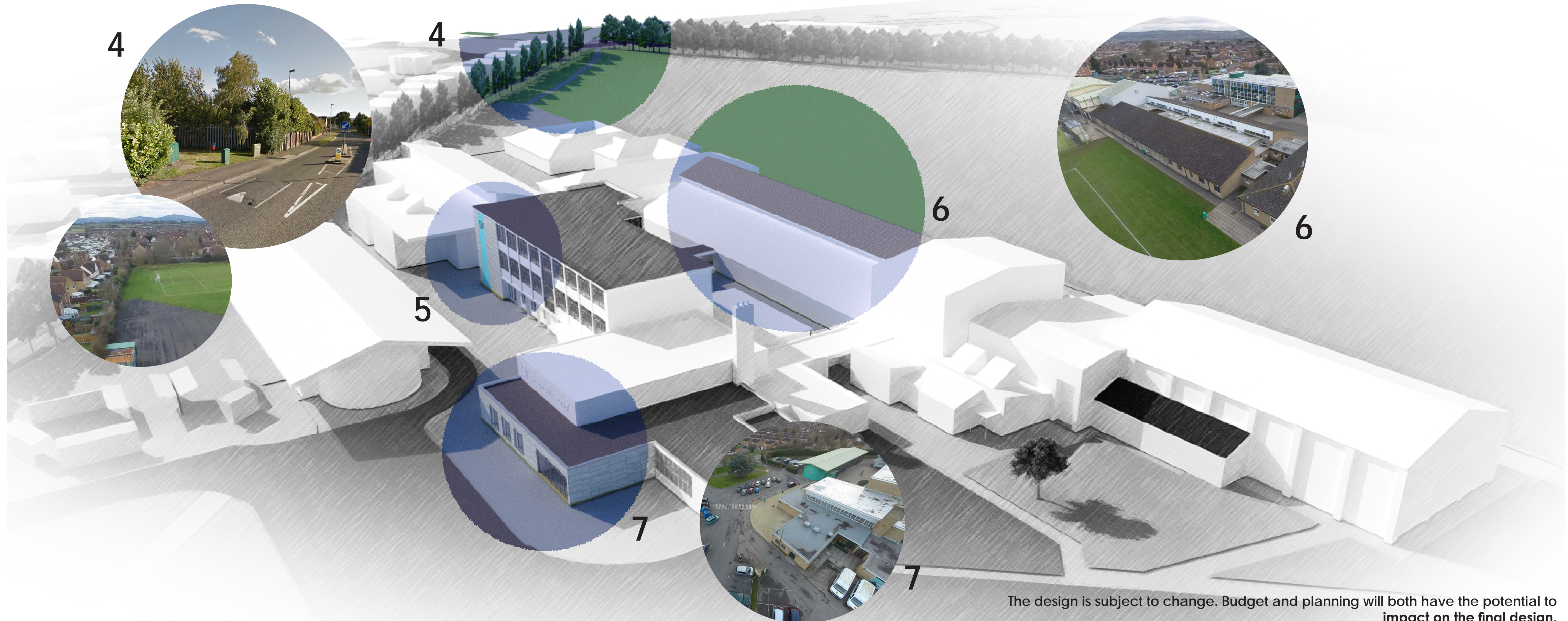

The design is subject to change. Budget and planning will both have the potential to impact on the final design.